



For your safety, call 811 at least 48 hours before you dig so that underground lines can be marked. This signature does not fulfill your obligation to call 811.

VERIFICATION OF PRIVATE UTILITY LINES	
<i>Mike Brown</i> CenterPoint Energy natural gas (shown). This signature verifies the location of the utility lines are not to be used for conflict verification.	11/29/23
<i>Mike Brown</i> CenterPoint Energy/UT	11/29/23
(This signature verifies the location of the utility lines are not to be used for conflict verification.)	
Signature Valid for six months.	



CAUTION!!
EXISTING UNDERGROUND UTILITIES IN THE AREA. CONTRACTOR IS RESPONSIBLE FOR DETERMINING THE HORIZONTAL AND VERTICAL LOCATION OF ALL UTILITIES PRIOR TO CONSTRUCTION. CONTRACTOR SHALL BE RESPONSIBLE FOR ANY REPAIRS TO EXISTING UTILITIES DUE TO DAMAGE INCURRED DURING CONSTRUCTION. CONTRACTOR SHALL NOTIFY THE ENGINEER OF ANY DISCREPANCIES ON THE

HMARK: PC FNW
HING: 10126739.94
NG: 3787708.54
=222.65

LAKE CONROE

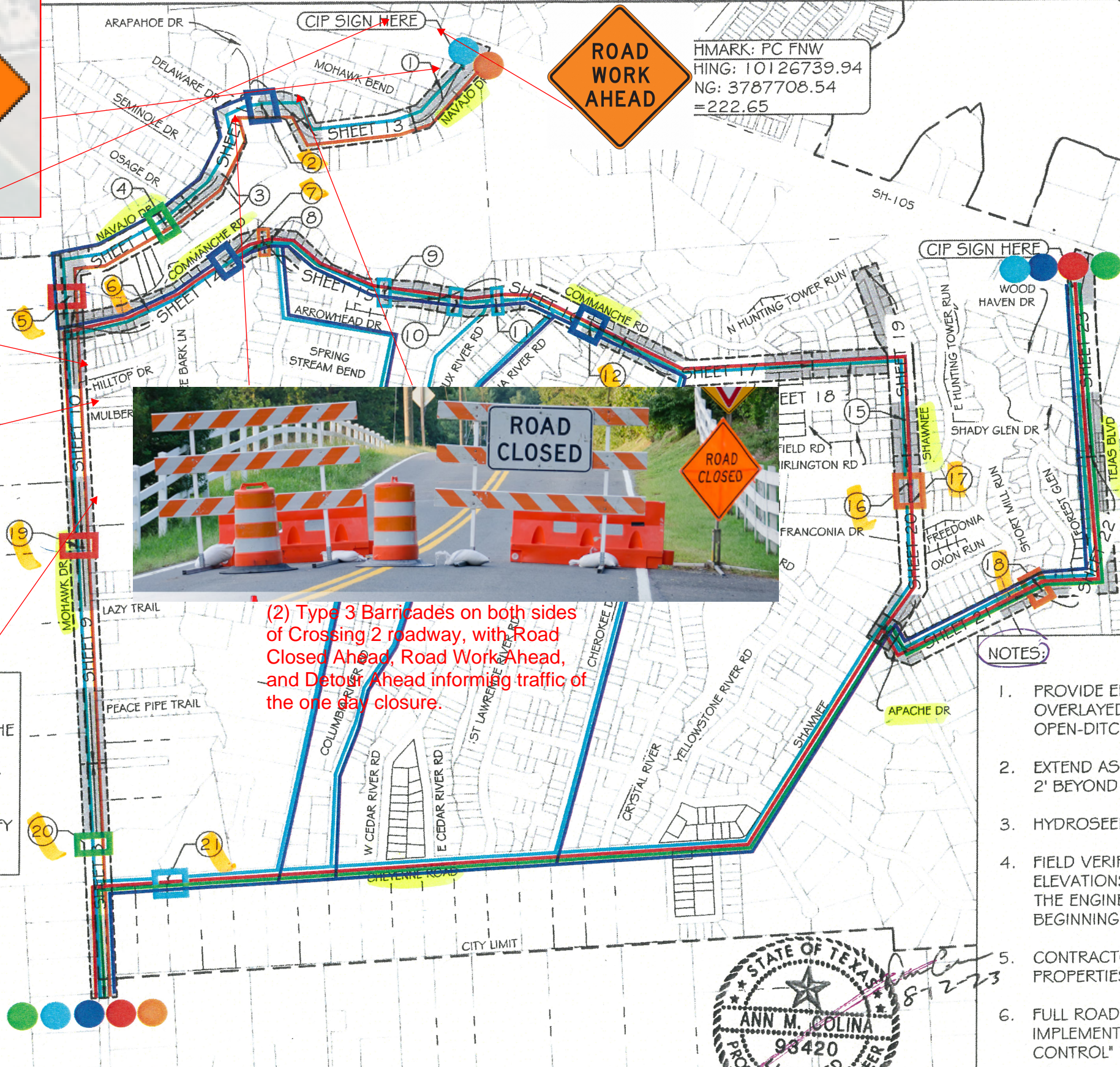

(2) Type 3 Barricades on both sides of Crossing 2 roadway, with Road Closed Ahead, Road Work Ahead, and Detour Ahead informing traffic of the one day closure.

KEYED NOTE
PROP. CULVERT CROSSING

- NOTES:
1. PROVIDE EDGE BACKFILL ALONG THE NEWLY OVERLAYED STREETS, AS NECESSARY, ON OPEN-DITCH SECTIONS. NO SEPARATE PAY.
 2. EXTEND ASPHALT STABILIZED BASE A MINIMUM OF 2' BEYOND EDGE OF ASPHALT PAVEMENT.
 3. HYDROSEED ALL DISTURBED AREAS.
 4. FIELD VERIFY ALL EXISTING CONDITIONS AND ELEVATIONS PRIOR TO CONSTRUCTION. NOTIFY THE ENGINEER OF ALL DISCREPANCIES PRIOR TO BEGINNING ANY WORK.
 5. CONTRACTOR TO MAINTAIN ACCESS TO PROPERTIES DURING CONSTRUCTION.
 6. FULL ROADWAY CLOSURE NOT ALLOWED. IMPLEMENT "ONE-LANE, TWO-WAY TRAFFIC CONTROL" PER TCP (1-2) -18.

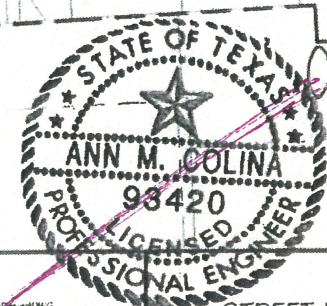

THE SEAL APPEARING ON THIS DOCUMENT WAS AUTHORIZED BY ANN M. COLINA, P.E. 93420

ON August 8, 2023

CITY OF CONROE
ENGINEERING
700 METCALF ST. P.O. BOX 3066
CONROE, TEXAS 77305 (936) 522-3100

DRAWING NAME: OVERALL LAYOUTS.DWG
PATH: H:\Projects\Projects\2022-01\Street Rehab - Lake Conroe Forest Phase I\Drawings
GRAPHIC SCALE:

SCALE: NTS

STREET REHAB - LAKE CONROE FOREST PHASE I

OVERALL - PROPOSED OVERLAY KEYSHEET
EXHIBIT - CULVERT WORK

"NOT FOR CONSTRUCTION" REVIEW ONLY

DRAWN BY: BH	Design By: EHR5
REVIEWED BY: AMC	
FLAT FILE NO:	
Project No: 2022-01	
SCALE: NTS	DATE: August 8, 2023
	Sheet No: 7